

Proliant™



PEDICLE SCREW
SYSTEM

SIMPLICITY.
SPEED.
SECURITY.

Simplicity.



The Proliant™ System is designed to provide secure fixation of the thoracolumbar spine while improving surgeon speed and ease-of-use. The low-profile design features a secure interlocking mechanism that stabilizes the construct, while Tightlok™ thread technology is designed to reduce screw pullout. Simple instrumentation and dual lead thread design increase speed-of-screw insertion, and the EZ Set Polyaxial Tulip Head allows surgeons to easily position the tulip head for rod insertion. The Proliant System is creating the new standard for simplicity, speed and security in spinal fixation.

EZ Set Polyaxial Tulip Head



The EZ Set Polyaxial Tulip Head allows the surgeon to easily position and set the tulip head.* The compression springs in the tulip head allow for smooth resistance to prevent tulip head rotation during rod insertion without creating friction.

Low-Profile Design and Maximum Range of Motion

The low-profile design (16.5mm head height and 12.5mm diameter) and the 60-degree maximum range of motion in the EZ Set Polyaxial Tulip Head make it easy to fit with any patient's anatomy.

Universal Tulip Head

The system features a universal tulip head, eliminating the need for more than one size set screw.

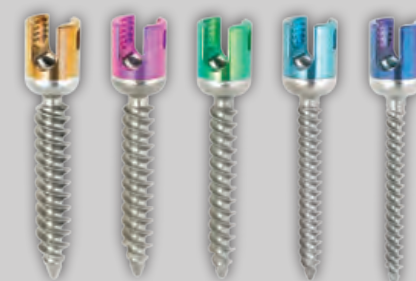

*Patent Pending

Speed.

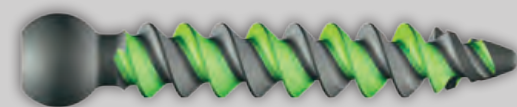

Dual Lead Thread

The dual lead thread allows the screw to be inserted twice as fast as standard screws, saving valuable time in the O.R.

Retaining Screwdriver

The Retaining Screwdriver attaches securely to the pedicle screw in axial alignment, which provides stability during implantation.



Double-Ended Set Screwdriver

The Double-Ended Set Screwdriver features a spring loaded hexalobe tip that retains the set screw and keeps it locked on securely. This allows the surgeon to pick up two set screws at one time and introduce them into the head of the tulip.



Rod Reduction

There is a special reduction screw and a variety of persuaders to provide easy insertion of the rod into the tulip head.

Security.

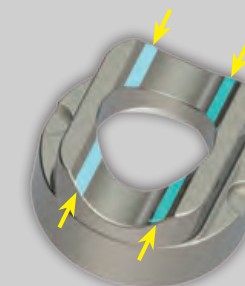
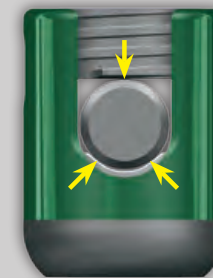

Tensioned Saddle Insert

The tensioned saddle insert maximizes contact between the set screw and rod interface by providing a three-point fixation that increases the security of the overall construct.

Hexalobe Drive

The hexalobe drive creates a positive engagement between the set screw and screwdriver, reducing the risk of screw stripping.

Optimal Torque

The system gives the surgeon optimal torque to minimize screw splay and secure the rod to the tulip.

Square Thread

The square thread on the set screw prevents cross threading, making it fast and easy-to-use.



352-377-1140
1-800-EXACTECH
www.exac.com



716-08-20
Proliant Brochure 0311



A Great Day in the O.R.™